

Operation Instructions

Make your choice...

M-601 Integrated safety beam sensor



1 Safety Instruction



Thank you for your purchasing our products, please read this manual carefully before use it.

2 Product Dimension

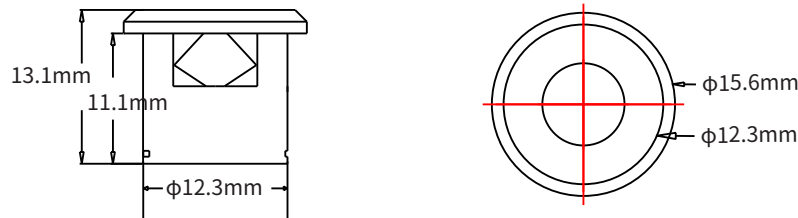

3 Overall characteristics

- Snap-on type shell design, easy to install.
- The control circuit is integrated in the light eye, no need external controller, flexible and convenient wiring.
- Imported receiving and transmitting infrared beam tubes, strong anti-sunlight interference performance.

4 Wiring Diagram

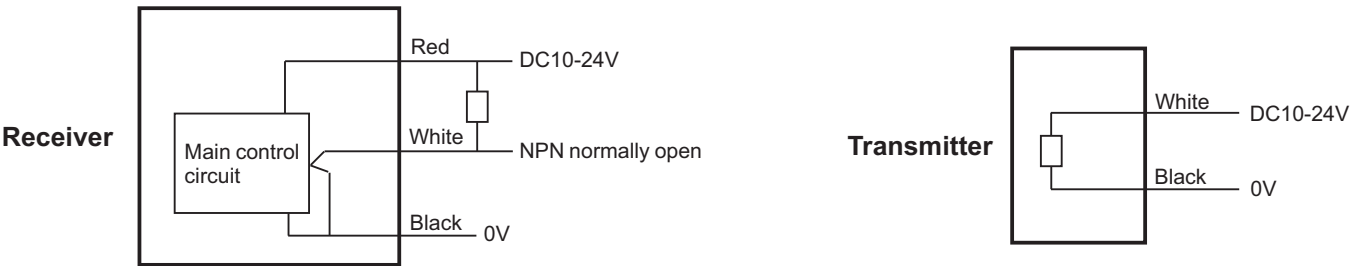

5 Parameters

Detection method: through-beam type	Infrared light source: 940nm
Detection object: opaque objects above 2cm	Action mode: cut off output
Distance: 10m	Output control: NPN open collector
Operating Voltage: DC 10-24V	Maximum load capacity: DC24V, 100mA
Transmit operating current: 12.6mA	Working humidity: 10-90%
Receive working current: 1.85mA	Working temperature: -20-45°C
Response time: 30ms	Cable specification: two cores for transmitting and three cores for receiving, 5.5m