

# Operation Instructions

Make your choice...

## M-708TW Electronic Tag (Wi-Fi)



### 1 Safety Instruction



Thank you very much for purchasing this product, in order to use this product correctly, please read this operating manual carefully before use.

### 2 Product Overview

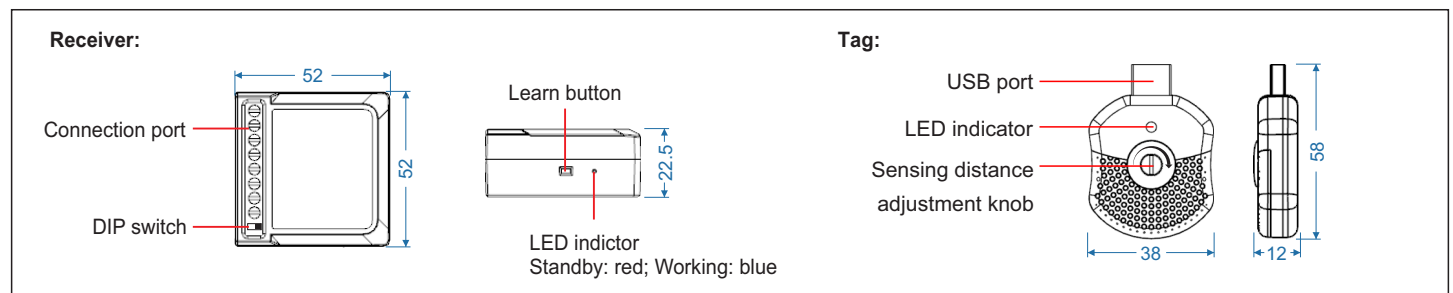

### 3 Wiring Diagram

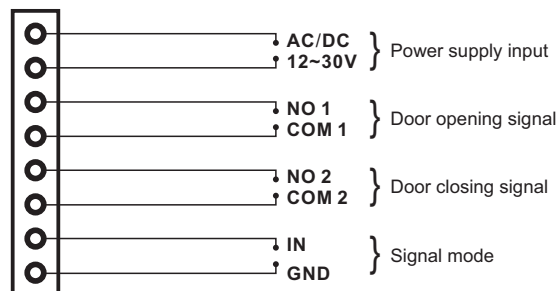

### 4 Product instructions

After the electronic tag is powered on, it will always transmit the door opening instruction, and the receiver will output the door opening signal when it receives the instruction, until the door opening instruction is lost then it will output the door closing signal. Examples are as follows:

#### (1) The car drives to the automatic door

- The car has not reached the response distance range, the automatic door will not open;
- The car has entered within the response distance, the automatic door opens automatically.

#### (2) The car leaves the automatic door

- The car is not out of the response distance range, the automatic door is still open;
- The car is out of the response distance, the automatic door closes automatically.

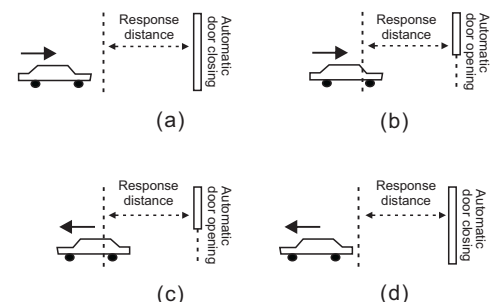

### 5 Function instructions

#### 1. The receiver learns the vehicle tag ID

a. Please press the learning button of the receiver once, the blue indicator light is on; b. Press the tag's button once; c. The blue indicator light of the receiver flashes, learning successfully. (NOTE: Up to 300pcs ID in total)

#### 2. Delete the matched tag's ID

Press and hold the learn button of the receiver for 5 seconds, the blue indicator light flashes quickly, all ID will be deleted.

### 3. Adjust the sensing distance between the electronic tag and the receiver



Adjust clockwise, the distance is more far, tag's indicator light flashes from slow to fast.

Adjust counterclockwise, the distance is more close, tag's indicator light flashes from fast to slow.

### 4. Receiver output signal instructions

#### 1) Door opening signal hold mode

Receiving the electronic tag instructions continuously, the door opening signal remains output, until the electronic tag instruction lost, and then output the door closing signal for 1 second.

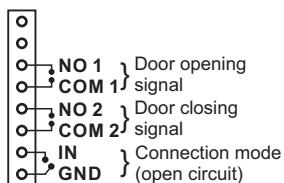

#### 2) Door opening signal inching mode

Receiving the electronic tag instructions continuously, the door opening signal output for 1 second, until the electronic tag instruction lost, and then output the door closing signal for 1 second.

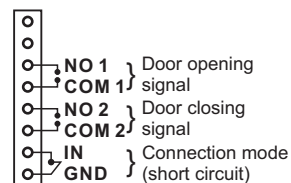

### 5.Receiver's wireless signal filtering settings

<p><b>Filter ON</b></p>	<p>Filter out the phenomenon that the door opening signal may sometimes not appear when the electronic tag signal is weak. It is recommended to use it in scenarios where the wireless signals of electronic tags, such as AGV cars will not be blocked.</p>	<p><b>Filter OFF</b></p>	<p>Improve the sensitivity, the receiver receives the electronic tag signal immediately output the door opening signal. It is recommended to use in the scene where the wireless signal of electronic tags such as cars will be blocked.</p>
-------------------------	--	--------------------------	--

**NOTE:** Receiver's green light is Wi-Fi module state indicator.

## 6 Technical parameters

Receiver:		Electronic Tag:	
Power supply:	DC/AC 12-30V	Power supply:	DC 5V~12V(USB port)
Static current:	26mA(DC12V power)	Action current:	50mA(5V power, max sensing distance)
Action current:	46mA(DC12V power)	Dimension:	58(L)x38(W)x12(H)mm
Frequency:	433MHz		
Dimension:	52(L)x52(W)x22.5(H)mm		
Sensing distance:	30 meters		

## 7 Packing List

No.	Name	QTY	Remark
1	Electronic tag	1	
2	Receiver	1	
3	3M tape	1	
4	Operation Instructions	1	

## 8 Networking setting

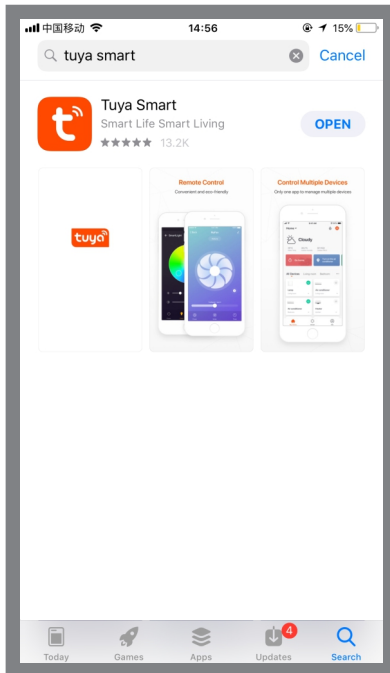

**Step 1:** Please search "Tuya Smart" APP in your mobile App market, click "GET" to install.

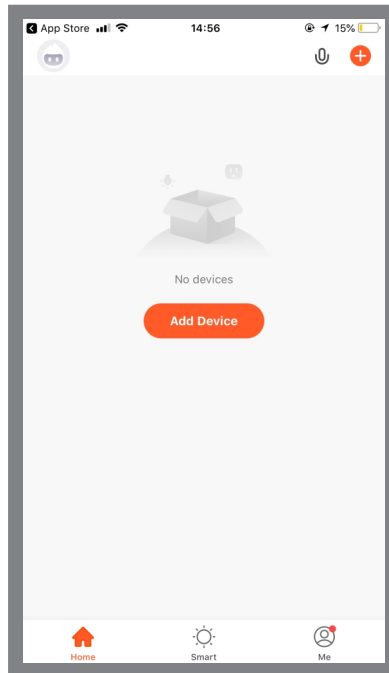

**Step 2:** Open this APP, click "Add Device".

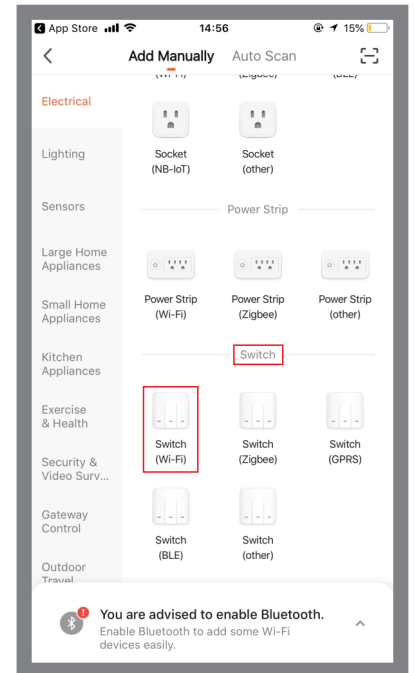

**Step 3:** In the "Electrical" category, find the "Switch" group, select "Switch(Wi-Fi)" and click "Next".

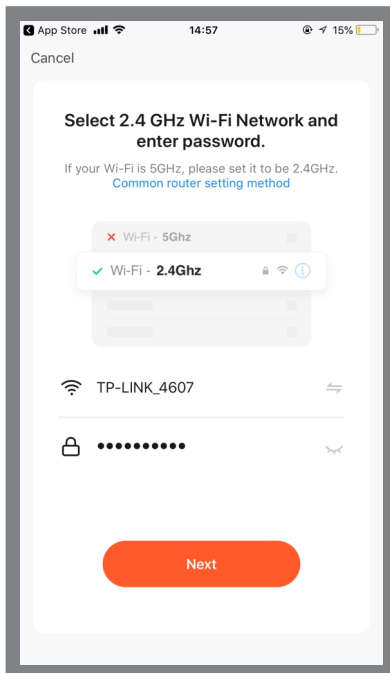

**Step 4:** Select the 2.4GHz Wi-Fi network and enter your password, click "Next".

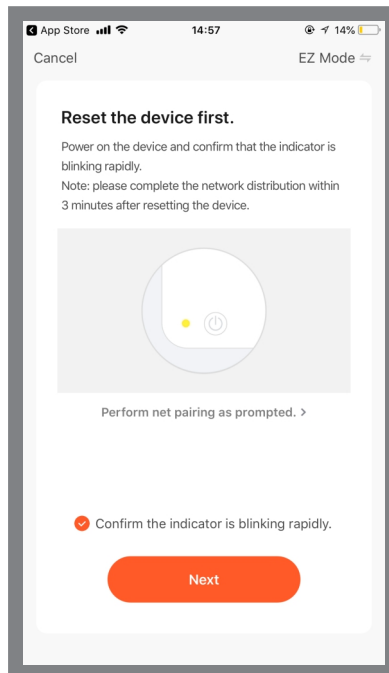

**Step 5:** Press and hold the controller WIFI learning button for 10s, WIFI blue light indicator is flashes, then check "Confirm the indicator is blinking rapidly" in the "tuya Smart" interface.

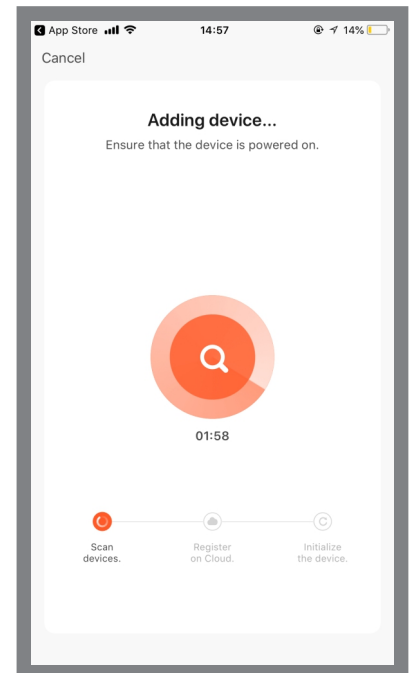

**Step 6:** Wait for the network connection to pair.

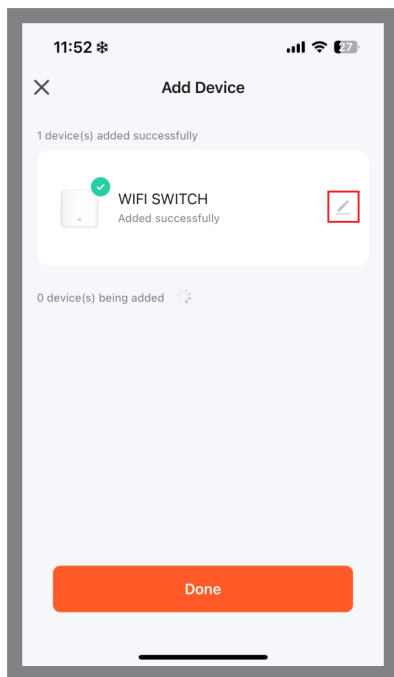

**Step 7:** If you need to change the device name, you can click the "✎" icon behind the "Electronic tags" to modify it.



**Step 8:** Press and hold "Unlock" button, door will open.

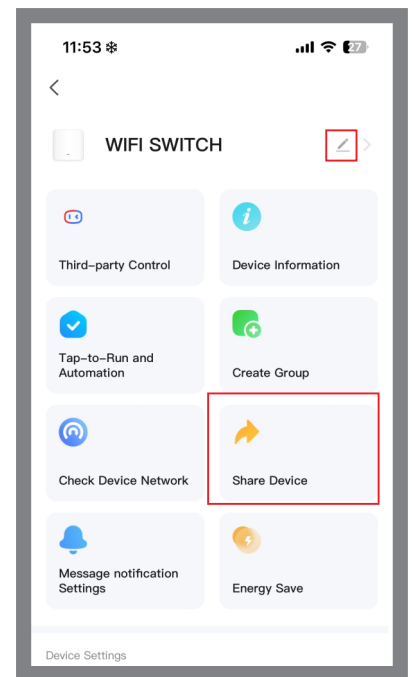

**Step 9:** Click the "✎" icon in the upper right corner, entering "System setting" interface, click "Share Device", can share the current device to other users.

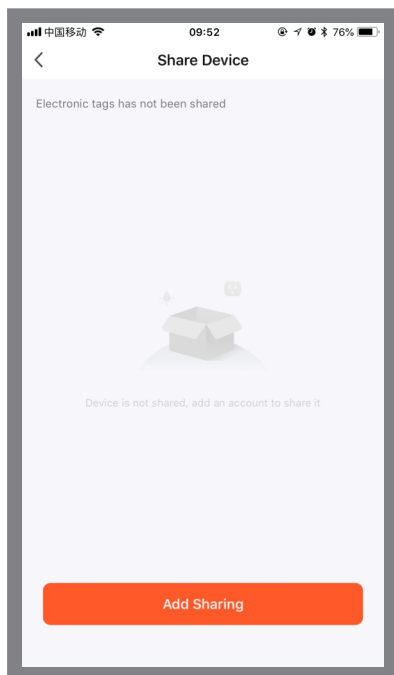

**Step 10:** Click "Add Sharing".

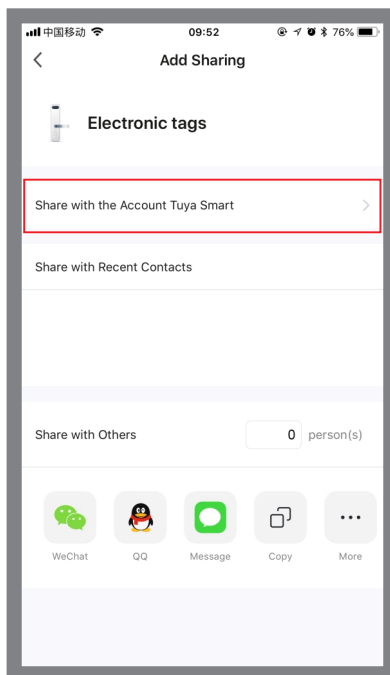

**Step 11:** Click "Share with the Account Tuya Smart".

## 9 System setting page function

- Device name: The current device's name, can be changed at any time.
- Device information: Virtual ID, MAC address, device time zone.
- Share device: Share the current device to other users.
- Create a group: Compose multiple devices into a group. After forming a group, you can open the door at the same time by operating multiple devices through the group icon.
- Add to Home Screen: Adds the current switch shortcut keys to the home screen.
- Device Upgrade: Displays the current firmware version of the device, which should be updated when a new version is available.
- Delete the device: After deleting the device, the device will erase the network settings and restore factory settings.